

Oxygen Movelite Duo/XL

Instructions & Care Manual

IMPORTANT: PLEASE CHECK YOUR EQUIPMENT

1 x Flysheet (or outer)

1 x Inflatable Roof Support Tubes

1 x Bag of Pegs

1 x Dual Action Hand Pump

2 x Reflective Endurance Storm Straps

1 x Repair Kit

1 x Holdall



We highly recommend that you insure your awning against storm damage or accidental damage, as the warranty does not cover such eventualities. The manufacturer is not liable for any damage caused to the awning or its contents because of misuse, incorrect pitching or extreme weather. (Full warranty details are at the back of this booklet).

IMPORTANT INFORMATION

- ⇒ Please do not leave for your holiday without fully erecting and checking you have all the contents for your awning. If you are missing anything please contact your retailer immediately before use.
- ⇒ Please also note that manmade fabrics are prone to condensation when the warm air and moisture inside the awning comes into contact with the colder outside of the awning fabric. You may also experience condensation in the tube sleeves. This is a perfectly natural occurrence and should not be confused with leaking. Ensure all Vortex Vents are open whenever possible to help combat condensation.
- ⇒ Ideally erect your awning for some period before use - allowing it to weather. 'Weathering' can take a few uses of the awning before it is fully effective. Seam sealant can be used to solve any persistent weeps. This process is completely normal.
- ⇒ Make sure before erecting, that you site the awning on clear level ground with no sharp objects underneath, and that all the zips are fully closed. (We recommend laying a groundsheet down to keep the awning dry and clean).
- ⇒ We suggest conducting a trial run of your awning to familiarise yourself with the set up and use of the awning. If you have any issues relating to pitching your awning please contact your dealer for help before going on holiday.
- ⇒ Please note this awning is designed as a 'touring' awning and not for permanent pitch.
- ⇒ After use always dry and air the awning before packing away to prevent mildew or mould.
- ⇒ Any dirt or stains can be removed by brushing or gently washing with warm water. DO NOT use detergents as this will destroy the waterproofing on the fabrics.
- ⇒ DO NOT cook or smoke in this awning; although the outer fabric is flame retardant treated it will still melt.
- ⇒ In the event of damage; please contact your retailer. If you cannot get in touch with them use our contact form on our website www.outdoor-revolution.com and our customer service team will be happy to assist.

OPTIONAL ACCESSORIES

- ⇒ Snugrug - Cosy, soft carpet to fit on top of the ground-sheet in your drive-away awning.
- ⇒ Zip on Canopy - Canopy with single pole and tooth comb zip.
- ⇒ Two Berth Inner Tent - clip in inner tent to fit inside the awning.
- ⇒ Stone Protection Groundsheet - groundsheet to fit under the groundsheet and protect the awning.
- ⇒ Trio Stripe Sleeping Bags - Available in different sizes, matching sleeping bags.
- ⇒ Selection of chairs and furniture.
- ⇒ Look at www.outdoor-revolution.com for more information.

LIFETIME GUARANTEE

The AirFrame Tubes come with a LIFETIME GUARANTEE*

You must sign up for the LIFETIME GUARANTEE on the Outdoor Revolution website for it to be valid.

Terms and Conditions apply - find the full terms and conditions on our website

PLEASE READ THE FOLLOWING ERECTION INSTRUCTIONS CAREFULLY

TIP: Refer to the photograph to help when pitching your Movelite Duo /DuoXL

1. Spread the flysheet out on the ground next to your vehicle with the cowl side laying parallel to your vehicle.



3. Peg down four corners of the awning using the adjustable pegging points. This keeps the awning in place whilst you inflate it. You may need to re-adjust them afterwards.

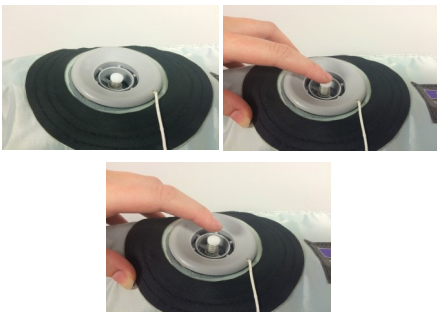

2. Take the awning piping on the cowl and slide it through the caravan awning channel until the awning is in the desired position on the vehicle. We recommend someone else holding the flysheet up whilst you do this.



4. Before inflating any of the AirFrame Tubes make sure the Dynamic Speed Valve quick release buttons are pressed out. This makes sure the air will be held inside the AirFrame tube.

5. Next, attach the pump to the first of the two Dynamic Speed Valves and begin to carefully inflate - taking care that no part of the fabric is caught anywhere.



7. Repeat steps five and six with the other AirFrame Tube. Then replace the caps and cover with the Velcro sleeve neatly to ensure the valve is covered.



9. Next, find the individual Air Tube roof support and again make sure the Dynamic Speed Valve quick release button is out. Inflate the individual Air Tube roof support until you can give it a good squeeze. Place the tube in the roof between the two tubes.



6. Inflate the AirFrame until you can give it a good squeeze. The tube needs to have room inside for air to expand. Don't worry if you do keep inflating - the Intelligent Frame will release any excess air. (Please note the Intelligent Frame is set to a limit of 5.5psi before it will release air).



8. Peg out and tension the front of the awning. Use the adjustable pegging straps to tension the awning as you desire. Make sure you don't over tension the fabric. If a door zip is too tight, release some tension before closing, never force the zip.



10. Peg out all the remaining pegging points and guy lines starting from the corner against the vehicle and work round the awning.



11. Peg out the Reflective Endurance Storm Straps for extra stability. Please make sure in heavier weather you use all the guy lines and storm straps to hold the awning in place.

12. Finally, locate the eyebrow canopy. Remove the grey adaptor from the included hand pump and use the smaller grey nozzle to inflate this tube.



WARNING: Never unzip the zips on the protective sleeves whilst the AirFrame Tubes are inflated. This will result in the tube bursting or ballooning out of the sleeve causing damage to the tube and the sleeve. This is not covered under the warranty.

PACKING AWAY YOUR AWNING

- ⇒ Zip up all the windows and doors before deflating.
- ⇒ Unpeg the guy lines, storm straps and most of the pegs around the awning - leaving the four corners pegged out.
- ⇒ Open each of the Dynamic Speed Valves in turn and press in the quick release button. Leave the button pressed in.
- ⇒ Unpeg the four corners and pull the awning out of the awning channel.
- ⇒ Lay the awning flat on the ground and push as much air out of it as possible.



- ⇒ Fold the awning lengthways from the opposite ends to the valves to push all the air out. Make a long thin sausage shape.



- ⇒ Measure the width of the bag up against the width of the folded awning to make sure the awning is going to fit.



- ⇒ Begin to roll the awning as tight as possible towards the valves to expel all the air as you roll.

- ⇒ Place the rolled awning on to the bag and pull the sides up round it. Finally, Zip up the bag.



TROUBLE SHOOTING

<u>PROBLEM</u>	<u>REASON</u>	<u>SOLUTION</u>
The Air tube keeps deflating after removing the pump.	The Dynamic Speed Valve button hasn't been pressed back out.	Press the quick release button back out to shut the valve.
The awning is leaking.	The awning requires weathering two or three time before it fully seals itself so you may experience a little bit of weeping. This could also be condensation, an inevitable occurrence.	Allow the awning to get wet then dry two or three times. Open all the vents to increase air flow and reduce condensation.
Bowing and Twisting of the tubes.	The tubes can twist inside the sleeves, particularly when packing away so next time the tube bows.	Unzip the sleeve whilst the tube is deflated and re-position the tube.

IN THE EVENT OF A PUNCTURE

If you have a small puncture in your Air Frame Tube you can easily repair it using the standard puncture repair kit.

- ⇒ To remove the Air Frame Tube - deflate the tube and then unzip the two protective sleeves over the tube and pull the Air Tube out. Do not unzip the sleeves whilst the tube is inflated.
- ⇒ Locate and repair the puncture on the Air Frame Bladder.
- ⇒ Place the Air Tube back in to the sleeves in the correct place with the valves in the valve hole. Make sure the Tube is straight and not twisted.
- ⇒ Zip the two sleeves back up fully.
- ⇒ Inflate the AirFrame Tube again, ensuring that the puncture has now been repaired.
- ⇒ If this process doesn't work you may have to buy a new bladder.

****Spare AirFrame Bladders can be bought to replace damaged ones. Visit the Spares Section at www.outdoor-revolution.com or contact us on 01924 455313****

****Awnings will not be replaced because of damaged bladders****

OUTDOOR REVOLUTION GUARANTEE

Outdoor Revolution products are designed and produced to the highest manufacturing standards. The best quality fabrics and components available are used for each specific item and rigorous checking of finished products is in place.

All finished products are:-

- Checked for, and are free of minor defects
- Are fit for the purpose/use that they are intended
- Are of a satisfactory quality

It is important that correct care is taken when opening the product, erecting, using and just as importantly, packing away the product. Following these rules will keep your product in reliable working condition for many years. Failure to adhere to these simple guideline may cause unnecessary damage to the product (see formal instructions for hints and tips on handling/erecting the product). A repair kit is included in the product to help resolve any minor issues.

THE WARRANTY

The Outdoor Revolution Warrant lasts for 12 months from the original date of purchase (please keep all receipts or copies of any relevant transaction to substantiate the purchase date). The warranty only covers workmanship and fabric/components. Any faults found within 6 months of purchase will be investigated by Outdoor Revolution. Faults found outside of the initial six months of purchase will need to be proven by you the purchaser, in line with current consumer legislation after the short term right to reject has ended.

Retailer will not refund a purchase if no fault is found. Product warranty must be registered **BEFORE** use via www.outdoor-revolution.com and as soon as possible from the date of purchase.

The manufactures warranty does not cover the following:-

- General wear and tear over extended periods of use or, seasonal pitching of the product.

THE WARRANTY (CONTINUED)...

- Accidental damage caused by but not exclusive to, human, animal or weather.
- Flaws in the fabric caused by excessive use.
- Water ingress through fabric as a result of UV degradation.
- Water ingress through seams caused by excessive abrasion of seams or taped seam.
- Broken zips caused by over tensioning, forcing or snagging.
- Over tensioned/stretched seams coming apart.
- Buckles subjected to undue force or abrasion.
- Lost/popped out eyelets.
- Broken holdalls.
- Pole breakages or tube punctures (where applicable).
- Collateral damage from a pole breakage.
- UV degradation.
- Condensation, (a natural occurrence, exacerbated by insufficient ventilation opening).
- Consequential damage/loss to property/belongings (either inside or outside of the product) or shortening of holidays.

Outdoor Revolution work very closely with our retail partners to manage all warranty repairs/issues. **Please contact your retailer immediately (even if purchased online) if you feel your Outdoor Revolution product has a genuine warranty issue. The retailer, in turn will raise the issue with ourselves and we will action; with the retailer, according to the nature of the claim.

Please ensure the product is clean and dry and as close to its original condition a possible before sending back for checking.

**Wet or dirty products will not be accepted back for checking/warranty claims.

** It is important to note that the Sales Contract between yourself and the retailer you purchased the Outdoor Revolution product from, remains valid throughout any warranty claim and your statutory rights are not affected.

Thank you for purchasing an Outdoor Revolution product, this product will give years of satisfactory service if basic instructions are followed, our products are designed for durability and for ease of erection.

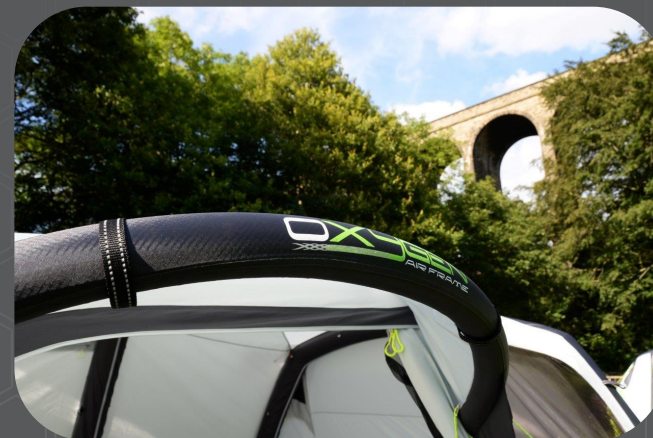

Outdoor Revolution Awnings are distributed by:

www.outdoor-revolution.com

Unit 1 Brick Park
Bretfield Court
Bretton Street Industrial Estate
Dewsbury
West Yorkshire
WF12 9BY



**OUTDOOR
REVOLUTION**
www.outdoor-revolution.com